

AC2251

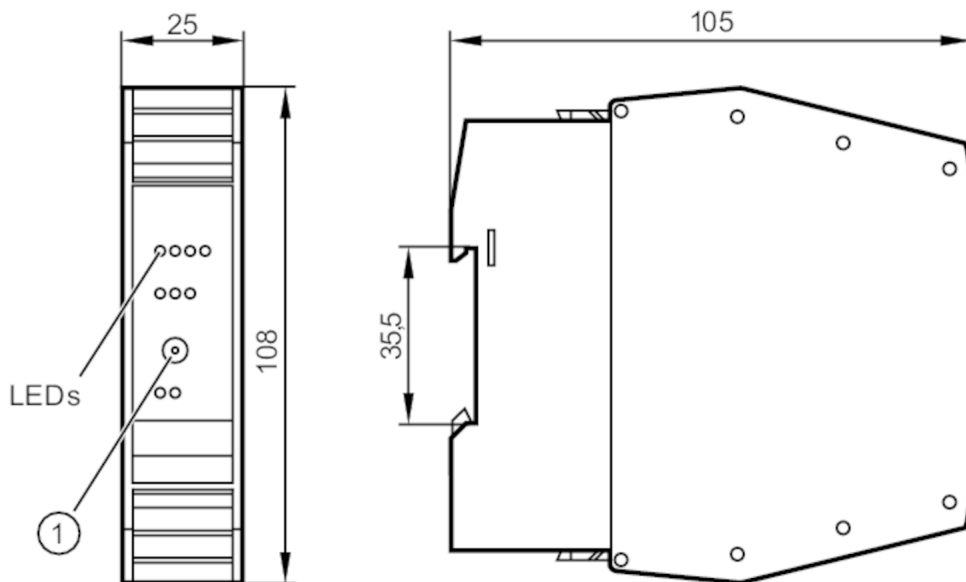

AS-Interface control cabinet module

SmartL25 4DI 4DO T C



1 Addressing socket



Application	
Application	I/O modules for control cabinet installations
Electrical data	
Operating voltage [V]	26.5...31.6 DC
Max. current consumption from AS-i [mA]	250
Additional voltage supply [V]	20...30 DC; (AUX)
Max. current consumption from additional supply [mA]	4000; (AUX)
Integrated watchdog	yes
Inputs / outputs	
Number of inputs and outputs	Number of digital inputs: 4; Number of digital outputs: 4



AS-Interface control cabinet module

SmartL25 4DI 4DO T C

Inputs					
Number of digital inputs	4				
Input circuit of digital inputs	PNP; (type 2 according to IEC 61131-2)				
Sensor supply of the inputs	AS-i				
Voltage supply [V]	18...30; (DC)				
Max. total current rating of inputs [mA]	200				
Input current High [mA]	6...10				
Input current low [mA]	0...2				
Min. switching level high signal [V]	11				
Digital inputs protected against short circuits	yes				
Outputs					
Number of digital outputs	4				
Circuit	PNP				
Voltage range DC [V]	20...30; (AUX)				
Max. current load per output [mA]	1000; (utilization category DC-12: 700 mA; utilization category DC-13 (control of electromagnets): 20 W (IEC 60947-5-1))				
Max. current load outputs total [A]	4				
Short-circuit proof	yes				
Electrically separated	yes				
Actuator supply outputs	AUX				
Operating conditions					
Ambient temperature [°C]	-25...70				
Max. relative air humidity [%]	90; (non condensing)				
Max. height above sea level [m]	2000				
Protection	IP 20				
Degree of soiling	2				
Tests / approvals					
EMC	EN61000-6-2				
	EN62026-2				
	EN50581				
MTTF [years]	184				
AS-i classification					
AS-i version	2.1; 3.0				
AS-i addressing	Addressing socket				
Extended addressing mode	no				
AS-i profile	S-7.0.E				
AS-i I/O configuration [hex]	7				
AS-i ID code [hex]	0.E				
AS-i certificate	37301				
Data bits	Data bit	D0	D1	D2	D3
	Input	I-1	I-2	I-3	I-4
	Output	O-1	O-2	O-3	O-4

AC2251



AS-Interface control cabinet module

SmartL25 4DI 4DO T C

Mechanical data		
Weight [g]	141	
Type of mounting	Mounting on DIN rail	
Material	PC-GF20	
Displays / operating elements		
Display	Switching status	LED, yellow I1...I4 O1...O4
	Power	LED, green AS-i AUX
	errors	LED, red
Accessories		
Accessories (optional)	cage clamps	
Remarks		
Remarks	Inputs and outputs must be electrically isolated.	
	Do not connect any of the following points to an external potential: I-, I+, I1, I2, I3, I4	
	The connections are electrically connected with the AS-i cable.	
Pack quantity	1 pcs.	
Electrical connection		
COMBICON:		
Connection		

I-	I-	I-	I-
I1	I2	I3	I4
I+	I+	I+	I+

O-	O-	O-	O-
O1	O2	O3	O4
A+	A-	E+	E-

AC2251



AS-Interface control cabinet module

SmartL25 4DI 4DO T C

A+	AS-i +
A-	AS-i -
I+	Sensor supply +24V
I-	Sensor supply 0V
E+	Actuator supply +24V
E-	Actuator supply 0V
I1...I4	Switching input sensor 1...4
O1...O4	Switching output actuator 1...4
O-	Switching output actuator 0V