

DI5009



Compact evaluation unit for speed monitoring

DIA3010-ZPKG/US-100-DPS

Article no longer available - archive entry

Alternative articles: DI5023

When selecting an alternative article and accessories please note that technical data may differ!

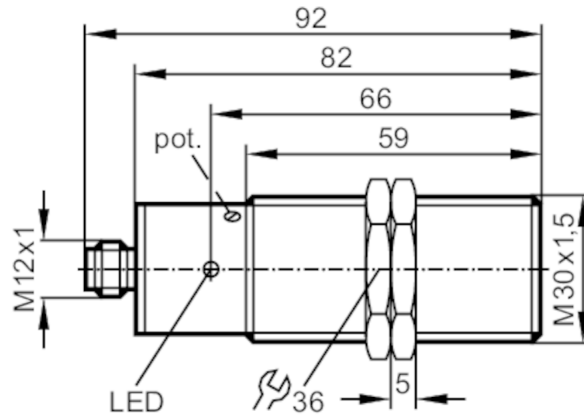

Product characteristics

Electrical design	PNP
Output function	normally open
Sensing range [mm]	10
Housing	threaded type
Dimensions [mm]	M30 x 1.5 / L = 82

Application

Special feature	Gold-plated contacts
Application	simple evaluation of rotating and linear movement with regard to underspeed; blocking

Electrical data

Nominal voltage DC [V]	10...36
Current consumption [mA]	< 15
Reverse polarity protection	yes

Outputs

Total number of outputs	1
Electrical design	PNP
Output function	normally open
Max. voltage drop switching output DC [V]	2.5
Permanent current rating of switching output DC [mA]	250
Short-time current rating of switching output [mA]	250
Short-circuit proof	yes
Overload protection	yes

DI5009



Compact evaluation unit for speed monitoring

DIA3010-ZPKG/US-100-DPS

Detection zone		
Sensing range	[mm]	10
Sensing range adjustable		no
Measuring/setting range		
Setting range	[Imp/min]	5...300
Accuracy / deviations		
Correction factor		steel: 1 / stainless steel: 0.7 / brass: 0.5 / aluminium: 0.4 / copper: 0.3
Hysteresis	[% of Sr]	10
Response times		
Start-up delay	[s]	15
Max. damping frequency	[Imp/min]	15000
Software / programming		
Adjustment of the switch point		multiturn potentiometer
Operating conditions		
Ambient temperature	[°C]	-25...80
Protection		IP 67
Tests / approvals		
MTTF	[years]	898
Mechanical data		
Weight	[g]	190
Housing		threaded type
Mounting		flush mountable
Dimensions	[mm]	M30 x 1.5 / L = 82
Thread designation		M30 x 1.5
Materials		brass special coating; PBT
Tightening torque	[Nm]	50
Displays / operating elements		
Display	switching status	1 x LED, green
Electrical connection		
Connector: 1 x M12; Contacts: gold-plated		
		

DI5009



Compact evaluation unit for speed monitoring

DIA3010-ZPKG/US-100-DPS

Connection

