

DTA200

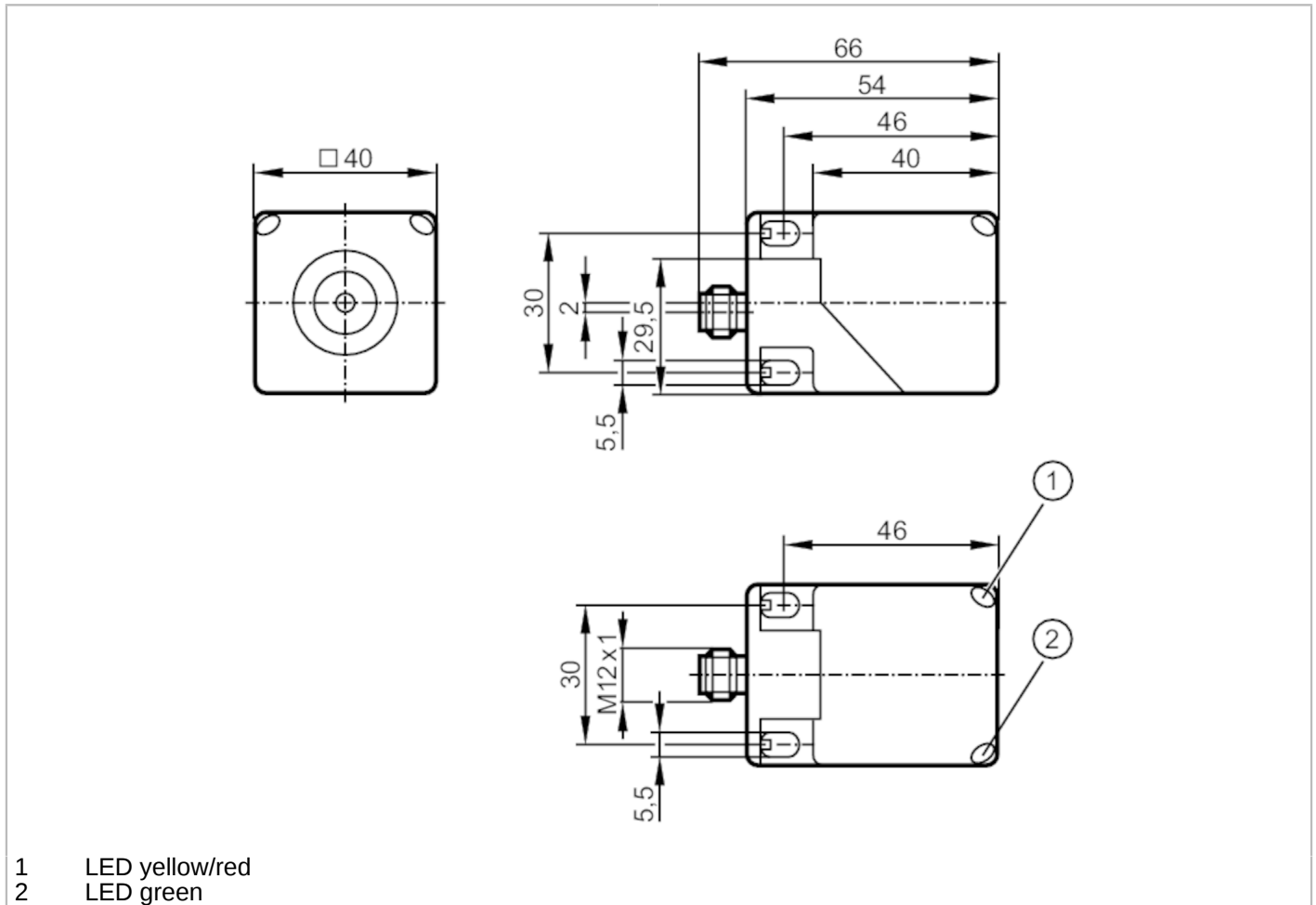

RFID read/write head with AS-Interface

DTSLF MCRWASUS01



Application	
Application	detection of objects on transport equipment
Radio approval for	EU; USA; Canada; Australia; Singapore
Electrical data	
Operating voltage [V]	26.5...31.6 DC
Current consumption [mA]	< 75
Protection class	III
Operating frequency [MHz]	0,125
Outputs	
Electrical design	AS-i

DTA200



RFID read/write head with AS-Interface

DTSLF MCRWASUS01

Detection zone			
Travel speed	[m/s]	< 0.5	
Distance read/read head front		150	
Distance read/read head side		150	
Note on distance read/read head		referred to	:
		Read/write head	DTA200
		Read head	DTA201
Distance write/read head front	[mm]	300	
Distance write/read head side	[mm]	300	
Note on distance write/read head		referred to	:
		Read/write head	DTA200
		Read head	DTA201
Distance to the ID tag	[mm]	read	:
		static	≤ 55
Interfaces			
Communication interface		AS-i	
Operating conditions			
Ambient temperature	[°C]	-20...60	
Storage temperature	[°C]	-25...80	
Protection		IP 67; IP 69K	
Tests / approvals			
EMC		EN 50295	1999-03
Shock resistance		EN 60068-2-29	40 g 6 ms
		EN 60068-2-27	50 g 11 ms
Vibration resistance		EN 60068-2-6	20 g 10...55 Hz
MTTF	[years]	456	
AS-i classification			
AS-i I/O configuration	[hex]	7	
AS-i ID code	[hex]	4	
AS-i certificate		87201	
Mechanical data			
Weight	[g]	211.5	
Housing		rectangular	
Sensing face		5 positions selectable	
Dimensions	[mm]	40 x 40 x 54	
Materials		PA	
Displays / operating elements			
Display		Operating voltage	1 x LED, green
		tag communication	1 x LED, yellow
		error AS-i data communication	1 x LED, red
Remarks			
Remarks		For the distances to other ID tags see the respective data sheet (E803xx)	
Pack quantity		1 pcs.	

DTA200



RFID read/write head with AS-Interface

DTSLF MCRWASUS01

Electrical connection

Connector: 1 x M12, rotatable, locking



Connection

