

E11027

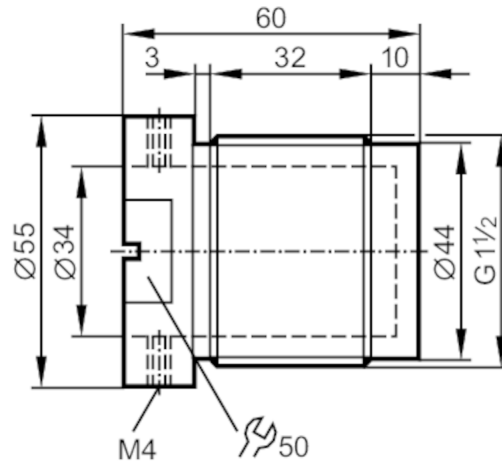

Mounting adapter for capacitive sensors

MOUNTING ADAPTER D34MM POM



Application	
Pressure rating	[bar] 8
Operating conditions	
Ambient temperature	[°C] -25...80
Mechanical data	
Weight	[g] 83.7
Dimensions	[mm] G 1 1/2 / L = 60
Thread designation	G 1 1/2
Materials	Adapter: POM
Sensor connection	clamp adapter Ø 34 mm
Process connection	threaded connection G 1 1/2 external thread
Remarks	
Pack quantity	1 pcs.