

# E11900

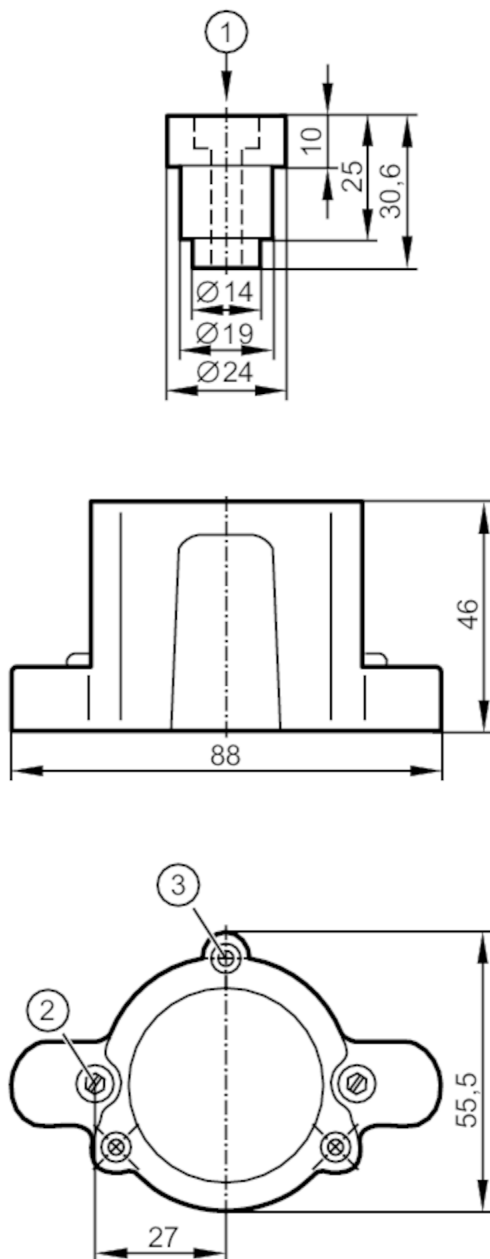

## Mounting adapter for position sensors used on rising stem valves

ADAPTER VALVIS\_04



- 1 socket head screw to fix the target on the valve piston
- 2 head cap screw M4 to fix the adapter on the valve
- 3 threaded hole M4 to fix the valve sensor on the adapter

Application	
Design	accessories for IX5010, IX5030, for valves Alfa Laval Typ SSV (Single Seat Valves)
Mechanical data	
Weight	[g] 160
Materials	Adapter: PA; Target: stainless steel (1.4404 / 316L)
Accessories	
Items supplied	socket head screw: 1 x M4
	socket head screws: 1 x M6
	Mounting plate

# E11900



## Mounting adapter for position sensors used on rising stem valves

ADAPTER VALVIS\_04

### Remarks

Pack quantity	1 pcs.
---------------	--------