

E74999

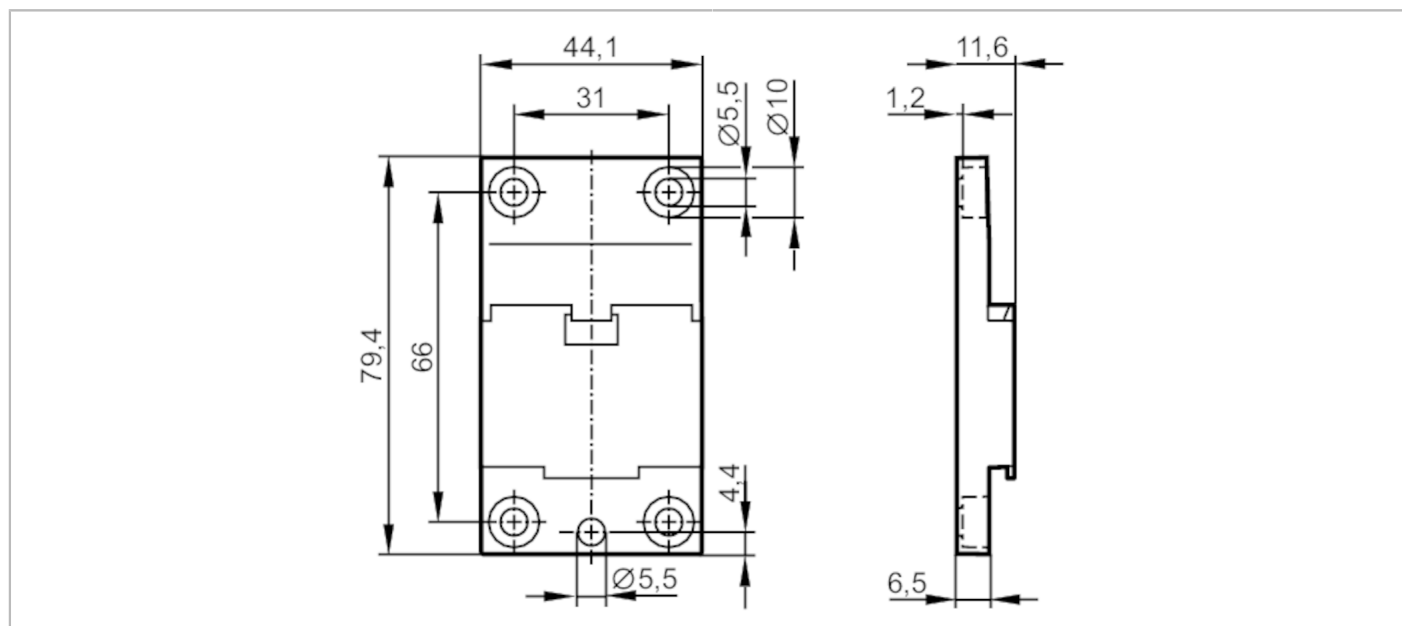

Mounting plate

Mounting plate 10 pcs.



Operating conditions		
Ambient temperature	[°C]	-20...70
Mechanical data		
Weight	[g]	199
Dimensions	[mm]	79.4 x 11.6 x 44.1
Materials		PA
Remarks		
Remarks		same fixing hole dimensions as FC lower parts (e.g. AC5000)
Pack quantity		10 pcs.