

Installation Instructions

UK

Accessory cover for filter system
for pressure sensors type PN

80261965 / 00 12 / 2016

E30432

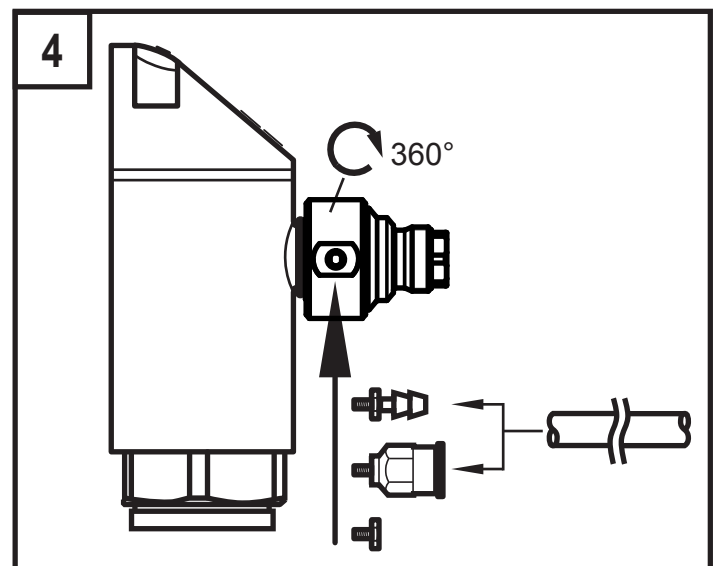
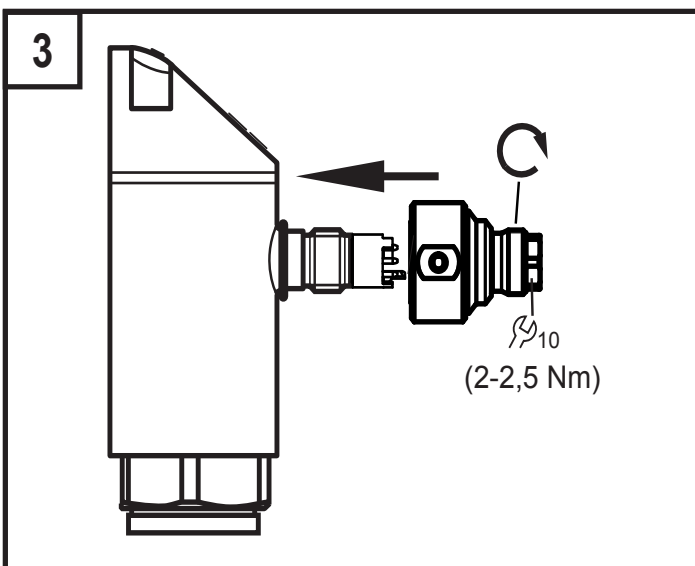
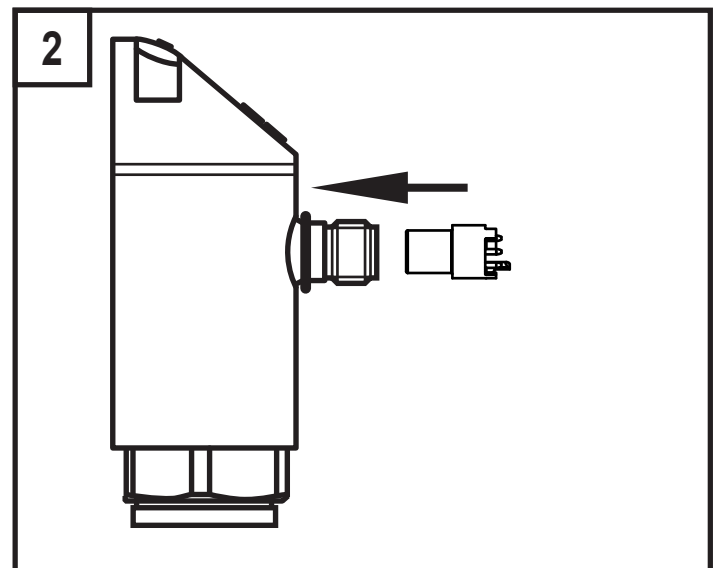
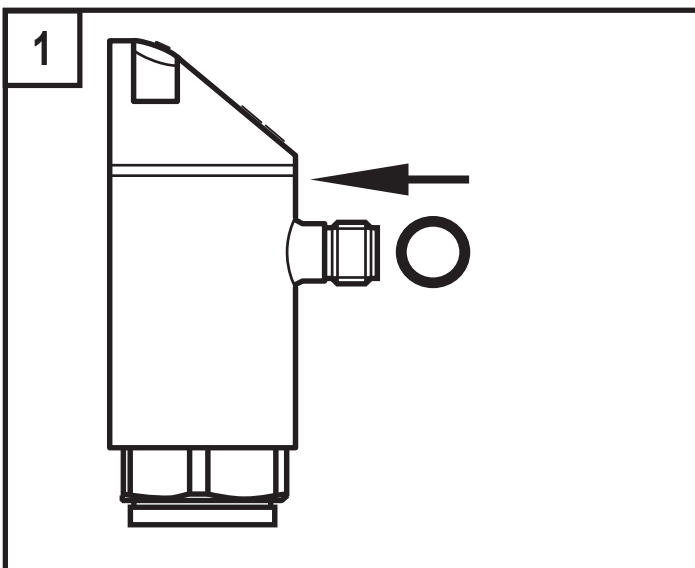
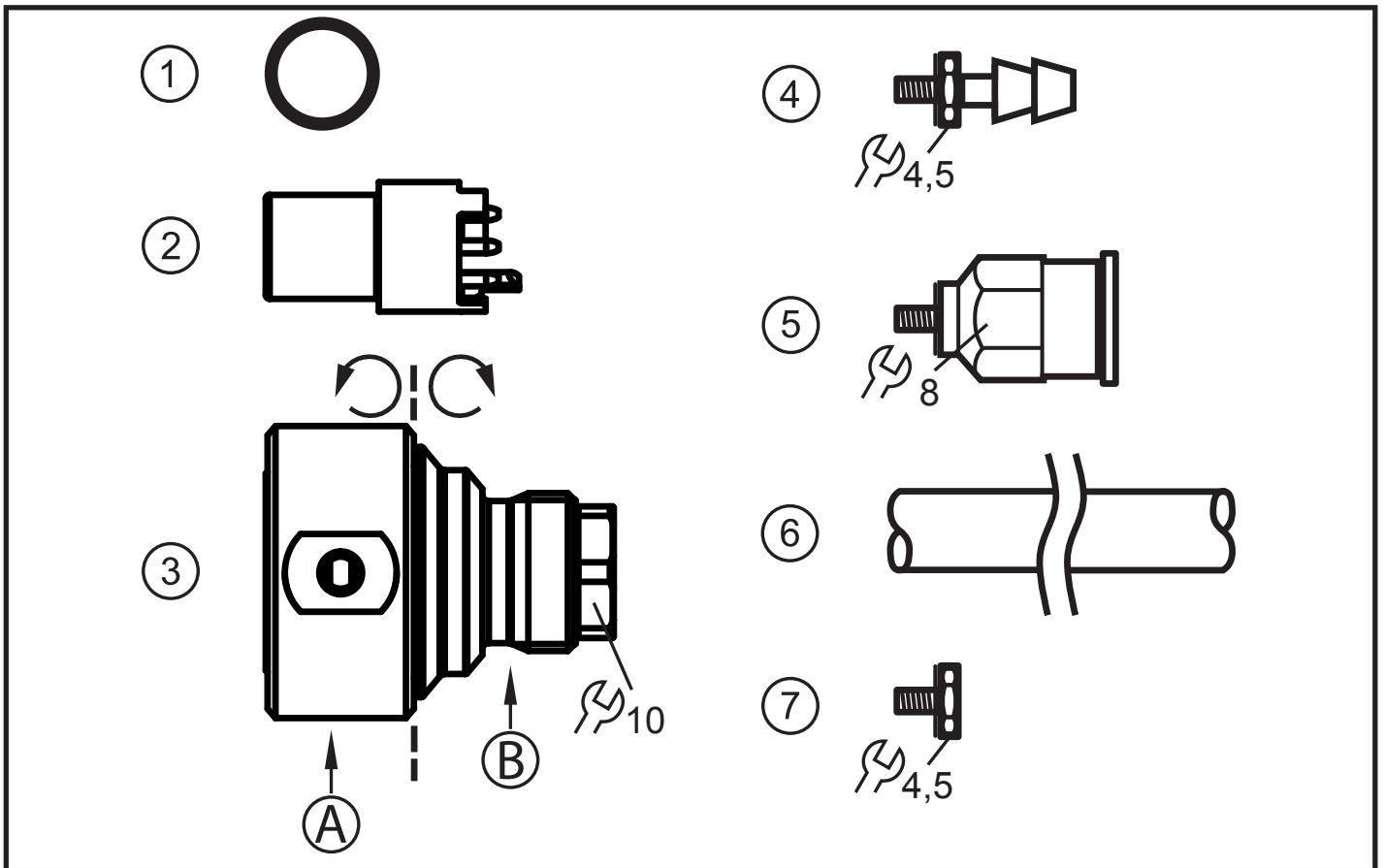



The accessory cover for filter system is only suitable for PN type pressure sensors (sensors with setting via 3 pushbuttons).

Contents

1. Sealing ring (FKM)
2. Plug insert (PEEK)
3. Filter cover (1.4404/316L, internal sealing rings: FKM)
4. Tube adapter (stainless steel, sealing ring: PA6)
5. Tube adapter with tube fitting (POM, brass, stainless steel, sealing ring: steel, NBR coated).
6. Tube (polyamide, harmless to the German Food and Consumer Goods Law para 5 section 1 clause 1 and clause 5)
7. Screw plug (stainless steel, sealing ring: PA6)

UK

Installation

- ▶ Slide the sealing ring (1) over the M12 connection of the unit.
- ▶ Insert the plug insert (2) into the M12 connection of the unit.



Filter cover (3): part A can be turned against part B

- ▶ Screw the filter cover (3) on the M12 connection of the unit (recommended tightening torque: 2 - 2.5 Nm).
- ▶ Turn the opening of the filter cover (3), part (A) to an area protected from media. Screw the adapter (4) or (5) into the thread connection of the filter cover (3). Attach the tube (6) to the adapter and lay the free tube end in a dry area protected from media.

Alternative

- ▶ Close the thread connection of the filter cover (3) using a screw plug (7).



When using the screw plug (7) there is no pressure compensation any more of the measuring cell.

This measure is only recommended if a small measurement error is acceptable. The following factors lead to a measurement deviation:

- Fluctuation of the atmospheric pressure
- Fluctuation of the internal device pressure in case of a temperature change ($\Delta 10 \text{ K} \leq 30 \text{ mbar}$).