

ifm electronic

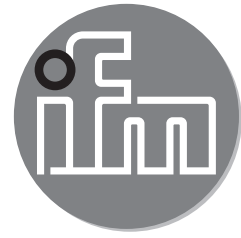

Installation Instructions  
Adapter with Aseptoflex thread

UK

**E3xxxx**

05/2011

704939/01

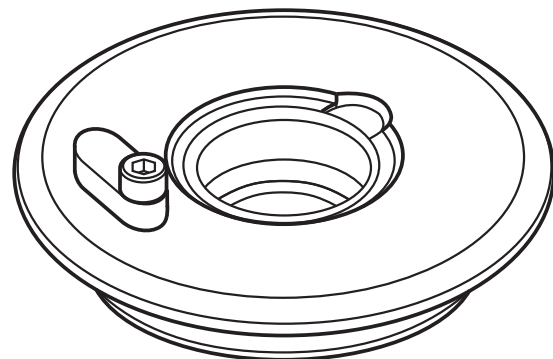

The adapter is delivered with EPDM O-ring fitted.

O-rings are also available as accessories:

- Order no. E30053 (5 pcs. Viton O-rings).
  - Order no. E30054 (5 pcs. EPDM O-rings).
  - ▶ Installation: Place the O-ring (A) in the groove (B) of the adapter. It must snap flush into the groove over its whole circumference.
  - ▶ Remove the O-ring (C) supplied with the sensor.
  - ▶ Grease the following parts with suitable paste (1):
    - thread and sealing areas of the sensor.
    - sealing areas and O-ring (A) of the adapter.
- The paste must be suitable and approved for the application and compatible with the elastomers used.

- ▶ Screw the sensor into the adapter until it is hand-tight. Do not damage the sealing chamfers.

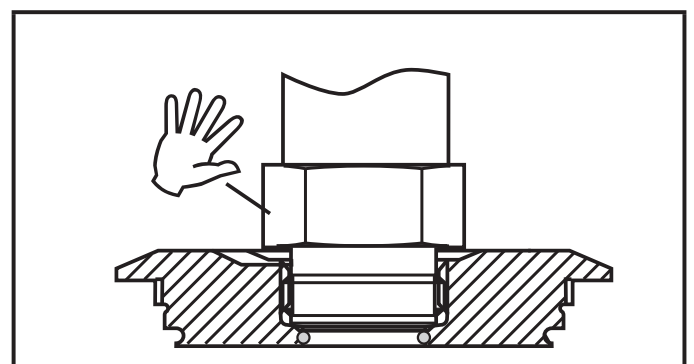
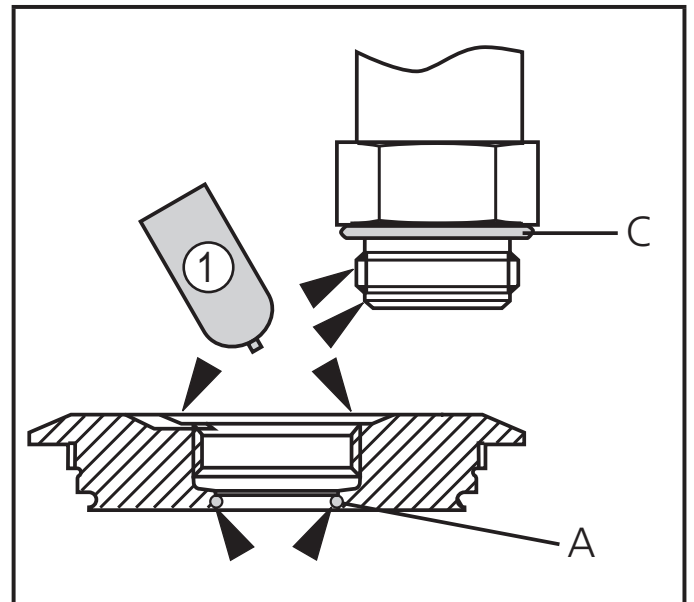
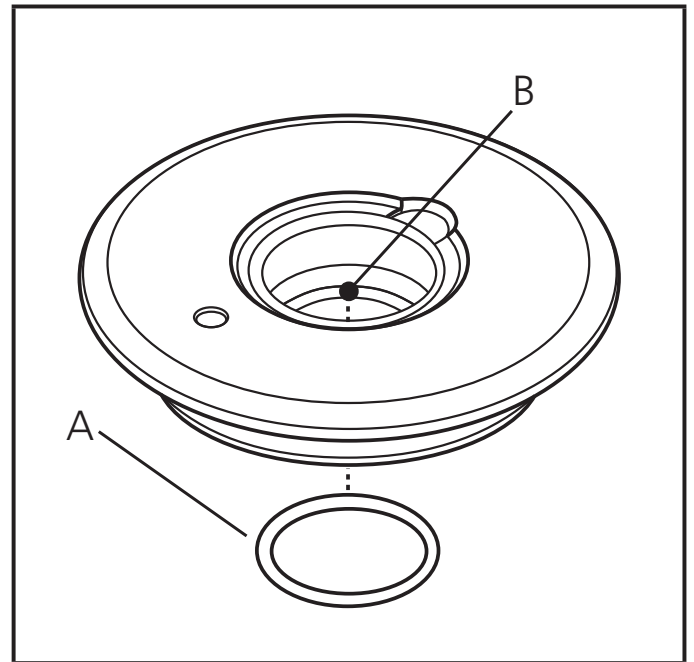

► Clamp sensor and adapter into a clamping device (D). The sealing chamfers (E) must not be damaged.

► Tighten the sensor using a spanner until you can feel the end stop

Note: Do not overtighten. This can have an adverse effect on the sealing.

► Hand tighten the eccentric element (G) on the adapter with the screw (F).

► Fix the sensor with the eccentric element and tighten the socket head screw.

► Mount sensor + adapter to the process connection by means of a clamp. The sensor and adapter assembly must be installed so that the adapter can properly drain during cleaning.

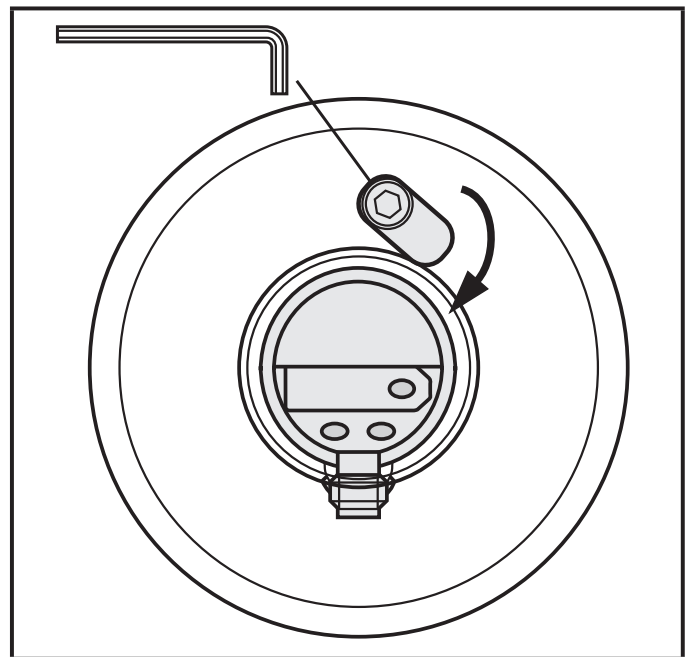
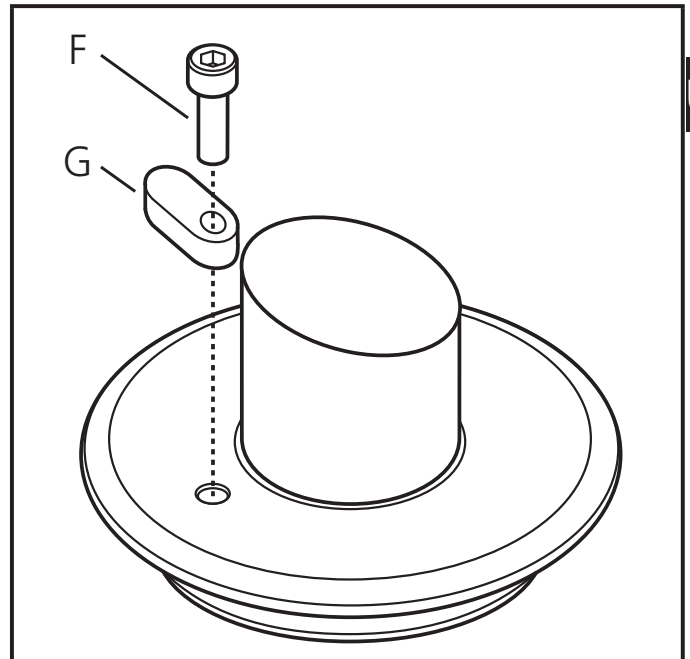
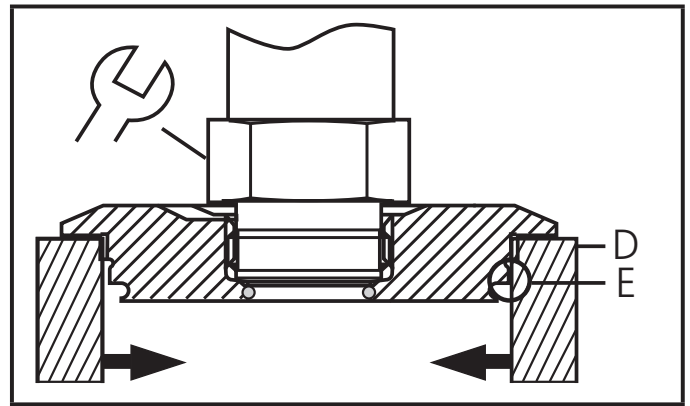

UK