



CE

Installation instructions
T splitter
E70354

UK

80275345 / 00 03 / 2021

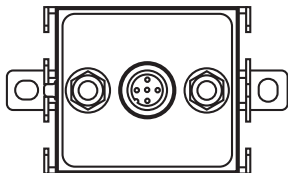

1 Preliminary note

Technical data, approvals, accessories and further information at www.ifm.com.

1.1 Symbols used

▶ Instructions

→ Cross-reference



Important note

Non-compliance may result in malfunction or interference.



Information

Supplementary note.

2 Safety instructions

- Read this document before setting up the product and keep it during the entire service life.
- The product must be suitable for the corresponding applications and environmental conditions without any restrictions.
- Only use the product for its intended purpose (→ Functions and features).
- If the operating instructions or the technical data are not adhered to, personal injury and/or damage to property may occur.
- The manufacturer assumes no liability or warranty for any consequences caused by tampering with the product or incorrect use by the operator.
- Installation, electrical connection, set-up, operation and maintenance of the product must be carried out by qualified personnel authorised by the machine operator.
- Protect units and cables against damage.

3 Functions and features

With the T splitter the AS-i voltage and external auxiliary voltage can be tapped via the M12 socket (current rating 4 A).

4 Installation



▶ Disconnect power before installation.



▶ Remove protective cap for M12 socket when the plug is connected (→ Step 3).

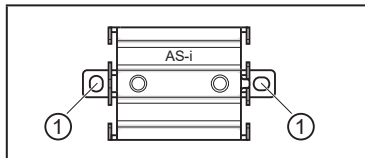

Step 1: Install lower part

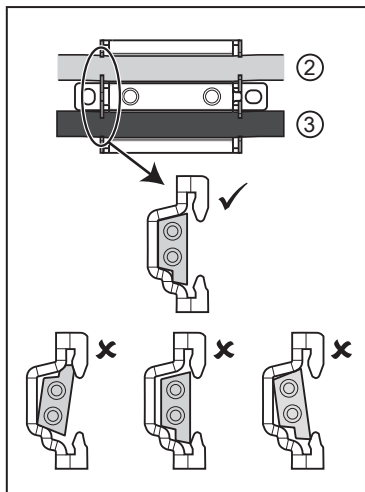

Step 2: Insert cable

- ▶ Choose a plane mounting surface.
- ▶ Fix the lower part to the mounting surface at the mounting holes (1).

UK

- ▶ Insert the yellow AS-i flat cable (2) into the cable duct "AS-i".
- ▶ Insert the black 24 V flat cable (3) into the other cable duct.



If no additional power supply is required:

- ▶ Instead of the 24 V flat cable insert the supplied cable dummy to close the unused cable duct.

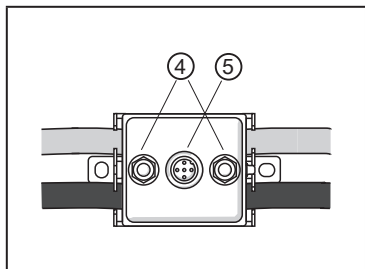

Step 3: Fit upper part

- ▶ Place the upper part.
- ▶ Tighten the fixing screws (4) alternately. Tightening torque 2.5 Nm.
- ▶ Remove protective cap from the M12 socket (5) and fix the M12 connector on the cable using the coupling nut. Tightening torque 0.6...0.8 Nm.

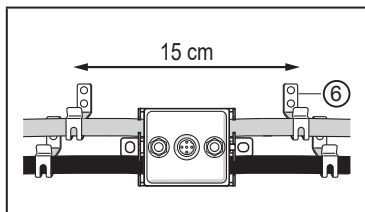

Step 4: Lay flat cable

- ▶ Lay flat cable; straight for a minimum of 15 cm.
- ▶ If necessary, use AS-i clips (6).



AS-i clips are not supplied with the unit. Information at www.ifm.com → Data sheet E70354 → Accessories.

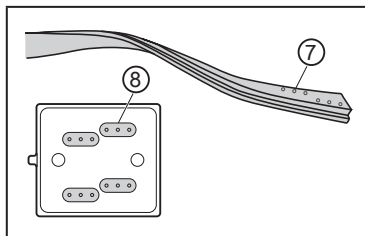

Step 5: Replace T splitter

- ▶ Note on replacement:
Precisely use the pierced points of the AS-i flat cable (7) or at least position within the black seal (8) of the T splitter.

5 Electrical connection



The unit must be connected by a qualified electrician.

- ▶ Disconnect power.
- ▶ Connect the unit as follows:

	Pin	Connection
	1	AS-i +
	2	0 V
	3	AS-i -
	4	+ 24 V
	5	not connected

UK